

MODEL	STOCK CODE	MINIMUM TORQUE AT RATED CURRENT (Nm)	RATED CURRENT (mA)	RESISTANCE ±10% @ 25°C (ohms)	VOLTAGE (Vdc)	NOMINAL POWER (watts)	MAXIMUM SPEED (RPM)	KINETIC POWER RATINGS			DE-ENERGIZED DRAG TORQUE @ 1000 RPM (Nm)	EXTERNAL INERTIA (kg cm ²)	TORQUE TO INERTIA RATIO (rad/s ²)
								AIR SUPPLY* (kPa)	5 MINUTE (watts)	CONTINUOUS (watts)			
AHB-24	006077	24.0	2400	10	24	57.6	12,000	620±35	5,300	3,000	1.36 X 10 ⁻¹	1.12 X 10 ²	2,140
								NO AIR	4,000	450			

SOLID MODEL AVAILABLE

- * AIR SUPPLY NOTES:
- CUSTOMER IS TO SUPPLY CLEAN, DRY AIR.
 - APPROXIMATE AIR CONSUMPTION IS: 567 liter/minute @ 620 kPa

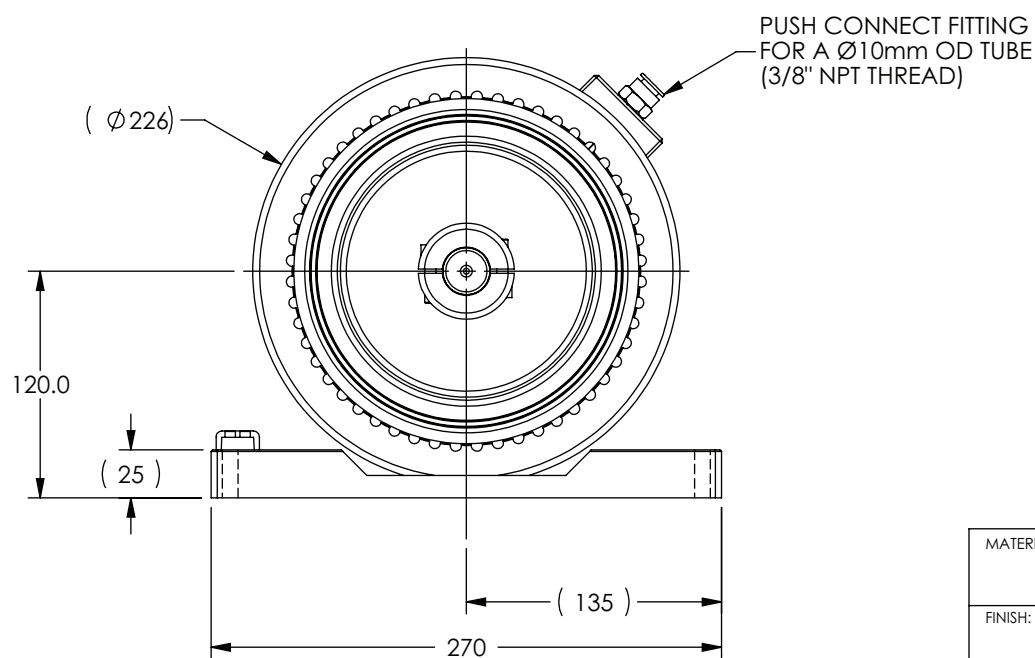
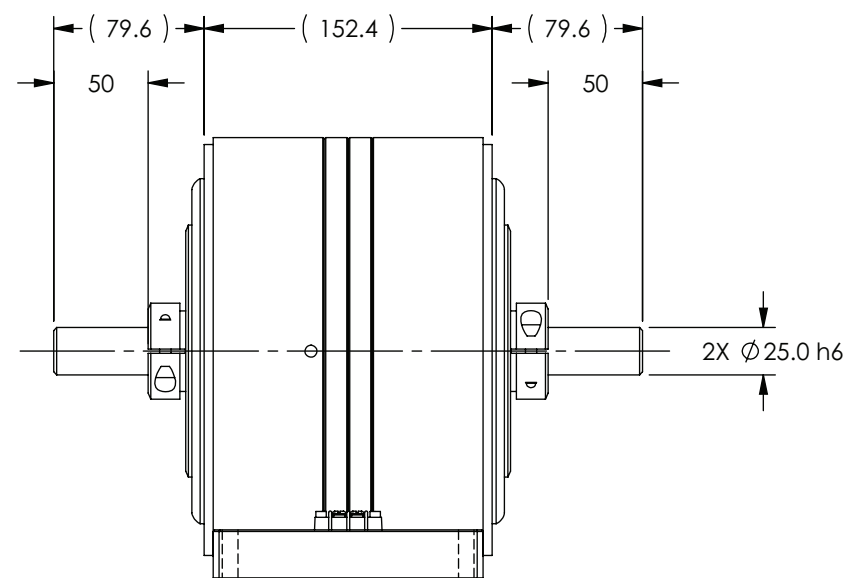
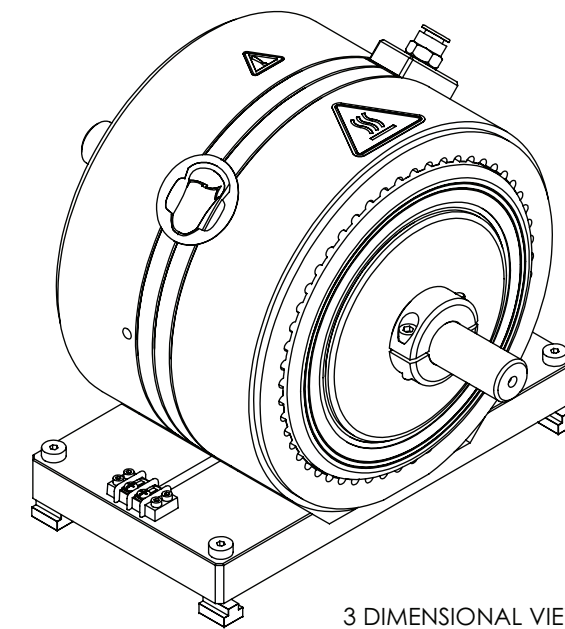
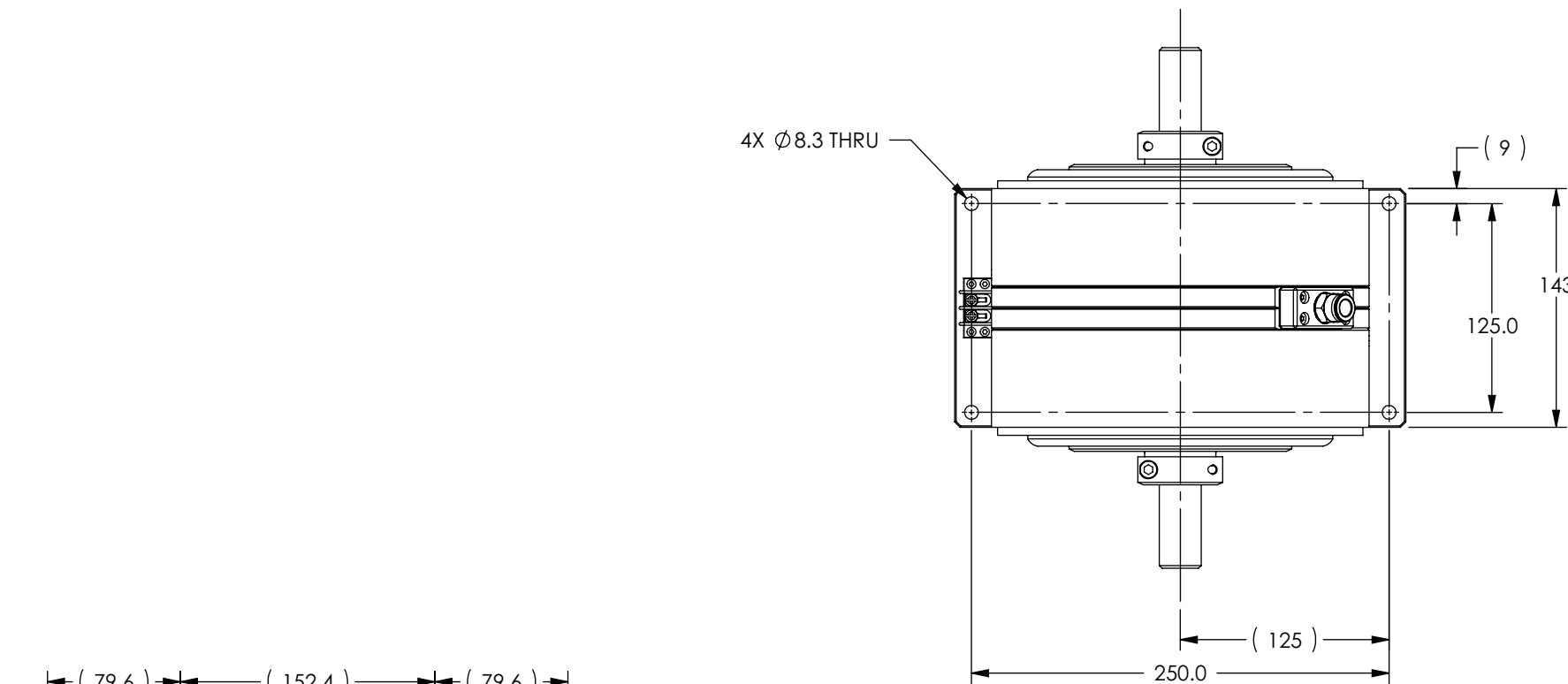

MATERIAL:	DESIGN	JEF	08/05/05
	DRAWN	JEF	11/08/05
FINISH:	CHECKED	AJC	03/21/06

MAGTROL INC.
70 GARDENVILLE PKWY, W.
BUFFALO, NEW YORK 14224-1322

UNLESS OTHERWISE SPECIFIED:
DIMENSIONS ARE IN MILLIMETERS,
DIAMETERS CONCENTRIC: .08 TIR,
FACES PERPENDICULAR: .08
INTERPRETATION PER ASME
Y14.5M-1994
REMOVE ALL BURRS AND BREAK
SHARP EDGES .13/.25 X 45°, ALL
INSIDE CORNERS TO BE .5 R MAX.
TOLERANCES:
X ± .4 .XX ± .13
.X ± .25 ANG. ± 1°
SURFACE FINISH 3.2 µm MAX. U.O.S.

TITLE AHB-24, AIR COOLED HYSTERESIS BRAKE		
USED ON: -	REV F	
SIMILAR TO: -	DWG. NO. AHB-24	
SIZE B	SCALE 1:4	SHEET # 3 OF 3

TYPICAL SOUND PRESSURE AT 1 METER: 110db



WARNING: HIGH SOUND LEVELS CAN CAUSE PERMANENT HEARING LOSS. USE HEARING PROTECTION WHILE THIS PRODUCT IS IN USE.