

SOLID MODEL AVAILABLE

MODEL	STOCK CODE	MINIMUM TORQUE (oz in)	MAXIMUM SPEED (RPM)	KINETIC POWER RATINGS		INPUT SHAFT INERTIA (lb in s <sup>2</sup> )	OUTPUT SHAFT INERTIA (lb in s <sup>2</sup> )	TORQUE TO INERTIA RATIO (rad/s <sup>2</sup> )
				5 MINUTE (watts)	CONTINUOUS (watts)			
HPM-32	006485	32	3,800	90	25	$1.4 \times 10^{-3}$	$8.6 \times 10^{-5}$	23,256

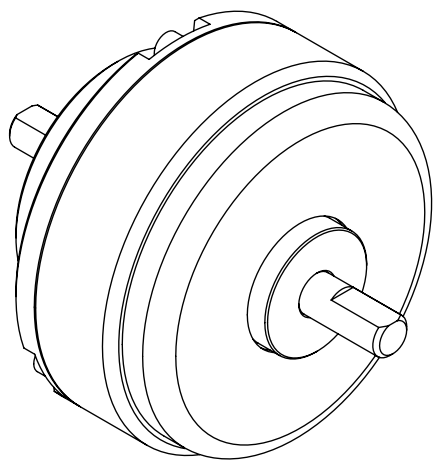
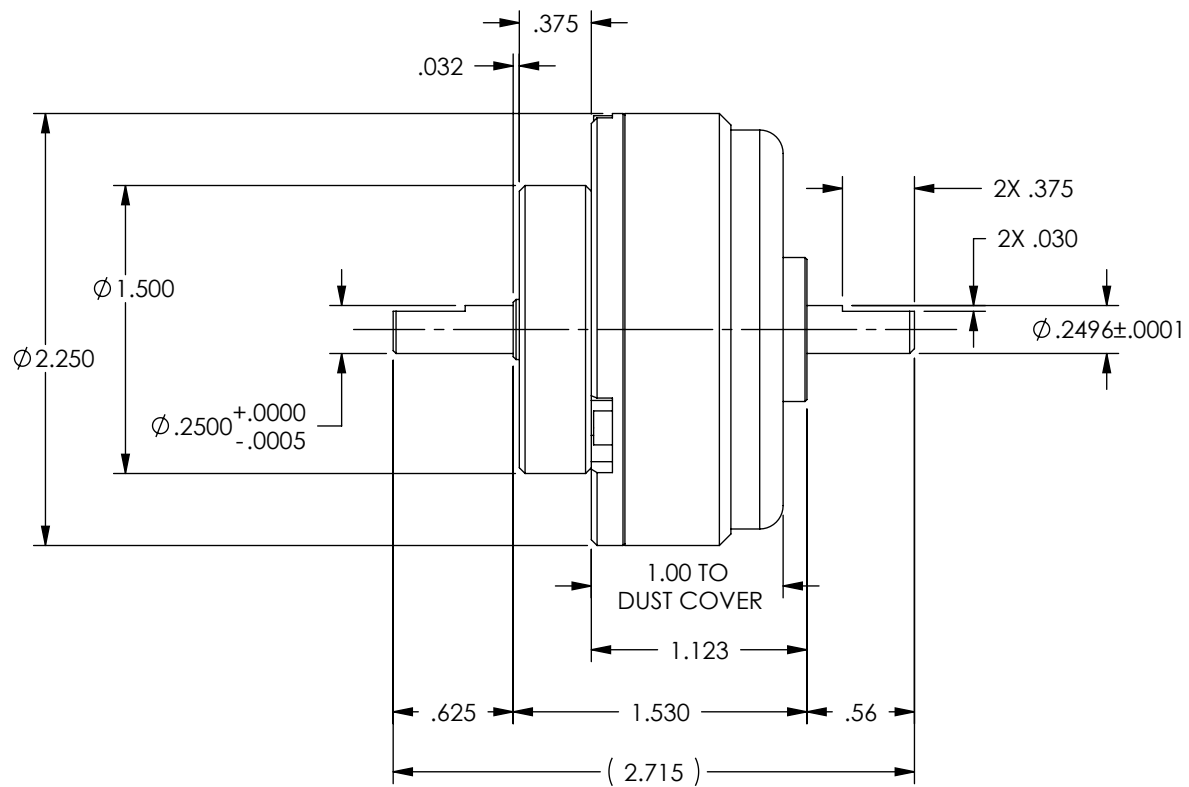
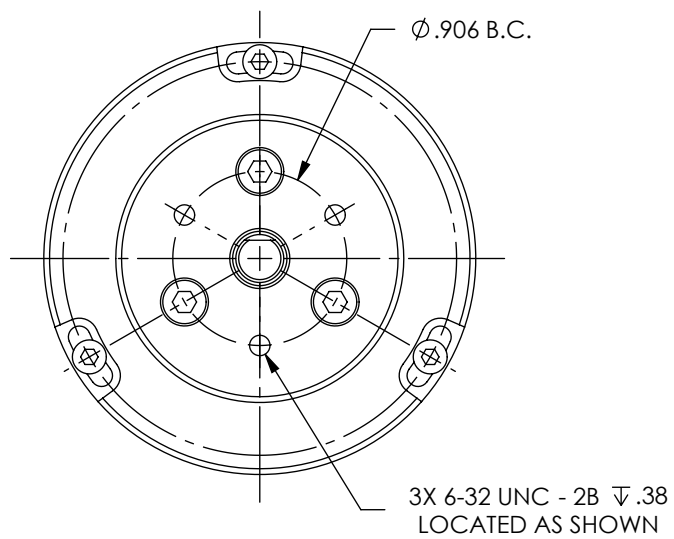

3 DIMENSIONAL VIEW  
SCALE 1 : 1

MATERIAL:	-	DESIGN	AJC	06/09/09	<b>MAGTROL INC.</b> 70 GARDENVILLE PKWY, W. BUFFALO, NEW YORK 14224-1322
FINISH:	-	DRAWN	AJC	06/09/09	
		CHECKED	DTW	06/09/09	
THIRD ANGLE PROJECTION		UNLESS OTHERWISE SPECIFIED: DIMENSIONS ARE IN INCHES, DIAMETERS CONCENTRIC: .003 TIR, FACES PERPENDICULAR: .003 INTERPRETATION PER ASME Y14.5M-1994 REMOVE ALL BURRS AND BREAK SHARP EDGES .005/.010 X 45°, ALL INSIDE CORNERS TO BE .02 R MAX. TOLERANCES: .XX ± .01      FRAC. ± 1/64" .XXX ± .005    ANG. ± 1° SURFACE FINISH 125 RMS MAX. U.O.S.			TITLE <b>HPMC-32 PERMANENT          MAGNET CLUTCH</b>
THIS DRAWING AND SPECIFICATION CONTAINS PROPRIETARY INFORMATION TO MAGTROL INC. ANY DISCLOSURE OR REPRODUCTION OF THIS DOCUMENT WITHOUT WRITTEN AUTHORIZATION FROM MAGTROL INC. IS EXPRESSLY PROHIBITED					USED ON: - SIMILAR TO: 003937 DWG. NO. <b>HPMC-32</b> SIZE <b>B</b> SCALE <b>1:1</b> SHEET # <b>3 OF 3</b>